



KOBBE

DOORTO DESIGN

KOBBE COLLECTION 2024

CONTEMPORARY BESPOKE ALUMINIUM FRONT DOORS



C O N T E N T S

KOBBE BRAND PRESENTATION	04 - 07
ALU DESIGN COLLECTION	08 - 19
ALU XGLASS COLLECTION	20 - 23
KOLEKCJA ALU QUARTZ	24 - 31
ALU QUARTZ COLLECTION	32 - 35
PIVOT COLLECTION	36 - 37
STANDARD HARDWARE	38 - 39
GLAZING AND SIDELIGHTS	40 - 41
STRUCTURED SURFACE	42 - 43
TIMBER FINISHES	44 - 45
CERAMICS AND TIMBER FINISHES	46 - 47
PULL HANDLES AND DOOR LEVER HANDLES	48 - 59
DOOR LOCKS / ELECTRIC STRIKES	60 - 61
SMART HOME	62 - 63
DOOR HINGES / DOOR CLOSERS	64 - 65
ACCESSORIES	66 - 67





Choosing KOBBE as your front door supplier means you're opting for unmatched quality and craftsmanship. KOBBE front doors stand as a hallmark of resilience, reflecting our commitment to advanced manufacturing processes and the use of superior materials from renowned sources. Your decision is a testament to prioritizing excellence and innovation in enhancing your home's aesthetic and functionality.



Each KOBBE door is a testament to distinctiveness and eco-friendly design. Embracing environmental responsibility, we utilize aluminum profiles comprised of 75% recycled content and ensure the recycling of production remnants. This strategy underscores our commitment to reducing our ecological footprint without compromising the unparalleled quality and individuality of our offerings.

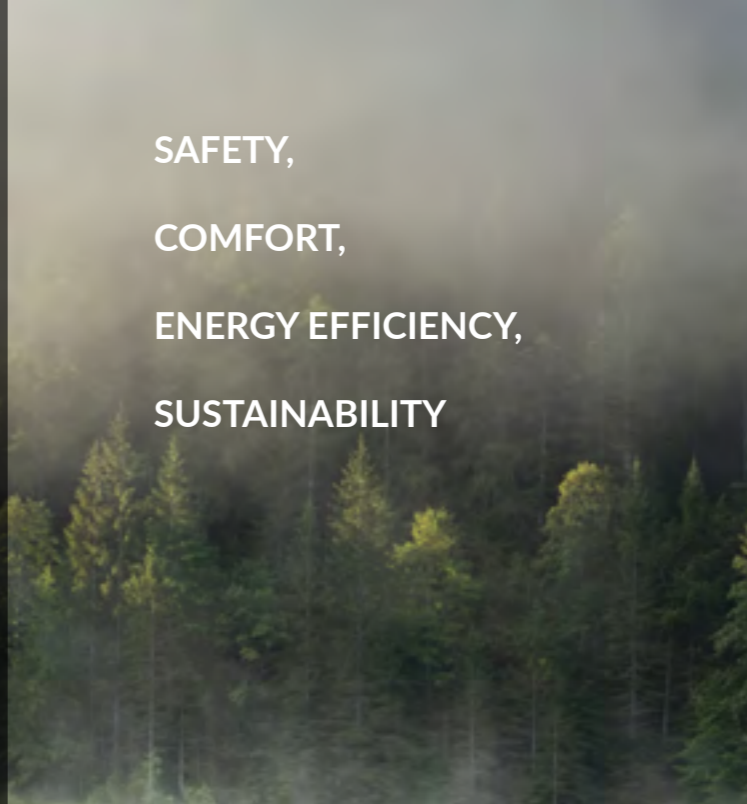

SAFETY,
COMFORT,
ENERGY EFFICIENCY,
SUSTAINABILITY



QUALITY
DURABILITY
ELEGANCE
INNOVATION

KOBBE goes beyond being merely a door, it represents an unparalleled blend of insulation performance and energy conservation. This choice guarantees your home is not only visually striking but also excels in retaining warmth and maximizing energy efficiency. With KOBBE, you're choosing a synthesis of elegance, sustainability, and lasting craftsmanship.



KOBBE aluminum front doors redefine security, meticulously crafted with safety glass and robust fittings to ensure they conform to the RC2 security rating. This commitment to protection means our doors are designed not just for aesthetic appeal but with a paramount focus on safeguarding your home against unauthorized entry, offering peace of mind and reliability.

K O B B E

MODERN DESIGN & AESTHETIC APPEARANCE

Immerse yourself in the captivating realm of KOBBE, where the innovation of modern aluminum doors is both crafted for and inspired by discerning customers. Welcome to a world where elegance meets functionality.

KOBBE front doors are crafted with meticulous precision, where attention to every single detail is paramount!

The cutting-edge technologies employed in crafting KOBBE front doors seamlessly integrate with modern smart home systems, ensuring perfect harmony and enhanced functionality.

KOBBE front doors present a contemporary design, complemented by an extensive palette of colours and a diverse array of features, tailored to meet various aesthetic and functional preferences.

Each configuration bestows our front door with an aesthetic and timeless design.

WHY SHOULD YOU CHOOSE KOBBE?

DURABILITY / HIGH WEATHER RESISTANCE

ENERGY EFFICIENCY / LOW THERMAL TRANSMITTANCE

SAFETY / ADVANCED BURGLAR PROTECTION SYSTEMS

CONTEMPORARY AND TIMELESS DESIGN



Bespoke aluminium doors



Coated in any RAL colour



RC2 security rating for enhanced protection



Design your own front door (applies to the Alu Design collection)



ALU DESIGN | ALU XGLASS | ALU QUARTZ | ALU WOOD | PIVOT

Collection Alu Design

The ALU DESIGN line of entrance doors uniquely characterizes your home's exterior and interior, reflecting its distinctive individuality.

The ALU DESIGN collection offers the opportunity to infuse your home with an original, contemporary, and distinctive style.

An impeccable blend of elegance, style, security, and longevity.

Each KOBBE front door model is customizable to comply with the RC2 security rating standard.

An extensive array of design and finishing choices.

A broad spectrum of colours

Ability to customize aluminum milling

A diverse array of glass types



The ALU DESIGN doors stand out with their versatile millings, glass choices, and stainless steel accents. The customisation possibilities further include a wide selection of colours, allowing you to pick any preferred hue from the RAL colour chart.

This collection offers the freedom to creatively tailor your front door to match your personal preferences.



KB 280

Aesthetic customization

Combine any two colors and design the door that enhances your most extraordinary interiors.



KB 400

Excellent lighting

This design combines aesthetics and functionality. Large glass surfaces provide excellent interior lighting.



KB 500

Modern and elegance

The contemporary design and refined appearance bestow a unique charm on the interior.



KB 640

Simple beauty

Sleek, geometric milling in its purest form elevates the aesthetic appeal of your home.



KB 110

Colour Milling Ral 3004 Custom, simple Width 300mm

Premium 75mm



KB 200

Colour Ral 9007

Premium 75mm

*also available in Alu Quartz



KB 210

Colour Accent Ral 6009 Ral 9005 width 300mm

Premium 75mm

*also available in Alu Quartz



KB 640

colour Milling Ral 5023 simple 10mm, 4 pieces

Premium 75mm

The visualization depicts the door in the dimensions of 1000 x 2100 mm.

The prices are valid for doors with dimensions up to 1300 x 2500 mm | Standard equipment (see p. 38) any color from the RAL palette (see p. 42) | any glazing package (see p. 40)



KB 650

Colour Milling Ral 5003
Type "v" 20mm
3 pieces

Premium 75mm



KB 670

Colour Milling Ral 3005
simple 10mm
3 pieces

Premium 75mm



KB 180

Colour Accent Ral 5010
Ral 9005
Width 300mm
Glass 150x150mm, 5 pieces

*also available in Alu Quartz

Premium 75mm



KB 220

Colour Glass Ral 7012
150x1500 mm

*also available in Alu Quartz

Premium 75mm



KB 280

Colour Accent Ral 8014
Ral 9005
Width 300mm
Glass 300x30mm, 5 pieces
Inox Accent 30mm, 5 pieces
flush with the surface

Premium 75mm



KB 350

Colour Glass Ral 9005
150x1500mm
Inox Accent Frame 40mm
flush with the surface

Premium 75mm



KB 400

Colour Glass Ral 7040
500x1800mm

Premium 75mm



KB 500

Colour Glass Ral 6005
150x1800mm
Inox Accent 10mm, 10 pieces
flush with the surface

Premium 75mm

The prices are valid for doors with dimensions up to 1300 x 2500 mm | Standard equipment (see p. 38) any color from the RAL palette (see p. 42) | any glazing package (see p. 40)

The visualization depicts the door in the dimensions of 1000 x 2100 mm.

The prices are valid for doors with dimensions up to 1300 x 2500 mm | Standard equipment (see p. 38) any color from the RAL palette (see p. 42) | any glazing package (see p. 40)

The visualization depicts the door in the dimensions of 1000 x 2100 mm.



KB 100



KB 120



KB 130



KB 140



KB 150



KB 250



KB 260

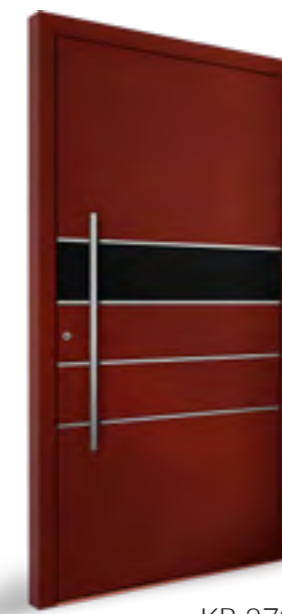

KB 270



KB 290



KB 300



KB 160



KB 170



KB 190



KB 230



KB 240



KB 310



KB 320



KB 330



KB 340



KB 360

The prices are valid for doors with dimensions up to 1300 x 2500 mm | Standard equipment (see p. 38) any color from the RAL palette (see p. 42) | any glazing package (see p. 40)

The visualization depicts the door in the dimensions of 1000 x 2100 mm.

The prices are valid for doors with dimensions up to 1300 x 2500 mm | Standard equipment (see p. 38) any color from the RAL palette (see p. 42) | any glazing package (see p. 40)

The visualization depicts the door in the dimensions of 1000 x 2100 mm.



KB 370



KB 380



KB 390



KB 410



KB 420



KB 480



KB 490



KB 510



KB 520



KB 530



KB 430



KB 440



KB 450



KB 460



KB 470



KB 540



KB 550



KB 560



KB 570



KB 580

The prices are valid for doors with dimensions up to 1300 x 2500 mm | Standard equipment (see p. 38) any color from the RAL palette (see p. 42) | any glazing package (see p. 40)

The visualization depicts the door in the dimensions of 1000 x 2100 mm.

The prices are valid for doors with dimensions up to 1300 x 2500 mm | Standard equipment (see p. 38) any color from the RAL palette (see p. 42) | any glazing package (see p. 40)

The visualization depicts the door in the dimensions of 1000 x 2100 mm.



KB 590



KB 600



KB 610



KB 620



KB 630



KB 660



KB TECH1



KB TECH2



KB TECH3

KOBBE utility doors, designed for exterior use, offer superior insulation and are available in three variants: fully glazed, panel-glazed, or solid with no glazing.

Basic equipment:

- Single-point lock,
- 3 pieces of anodized EV1 roller hinges,
- PZ BKS Series 88 lock cylinder,
- H1 door handle on both sides,
- all structural or matte colors (see p. 24),
- Triple-glazed safety glass, 44mm with warm edge,
- Insert panel 44mm.

The prices are valid for doors with dimensions up to 1300 x 2500 mm | Standard equipment (see p. 38) any color from the RAL palette (see p. 42) | any glazing package (see p. 40)

The visualization depicts the door in the dimensions of 1000 x 2100 mm.





ALU DESIGN | **ALU XGLASS** | ALU QUARTZ | ALU WOOD | PIVOT

Collection **Alu Xglass**

Combination of aluminum and glass. A technologically advanced solution with an incredible aesthetic appearance.

The fusion of a glossy glass surface with aluminum lends a distinctive character to the door.

The aluminium part can be made in any RAL colour. The glass is available in black.

Aesthetic combination of aluminum and glass

Black glass accents

Aluminum surface available in any RAL colour

Variety of designs





KB 1000

Colour Ral 7016
Glass accent Ral 9005
Width 30mm
Glass Glass 100x1500 mm
Inox Accent 10mm, 4 pieces
Flush with the surface
Pull handle Livello

Premium+ 78mm



KB 1010

Colour Ral 7016
Glass accent Ral 9005
Width 200mm
Glass Glass 100x1400mm
Inox Accent 10mm, 4 pieces
Flush with the surface

Premium+ 78mm



KB 1020

Colour Ral 7016
Glass accent Ral 9005
Width 150mm
Glass Glass 80x1500mm
Milling simple 10mm 4 pieces

Premium+ 78mm



KB 1030

Colour Ral 7016
Glass accent Ral 9005
Width 400mm
Glass Glass 300x1700mm
Milling simple 10mm, 4 pieces
Pull handle Q90 P 40x20

*available in the Alu Quartz collection

Premium+ 78mm



KB 1040

Colour Ral 7016
Glass accent Ral 9005
Width 200mm
Glass Glass 100x1400mm
Milling Type "V" 10mm

Premium+ 78mm



KB 1050

colour Ral 7016
Glass accent Ral 9005
Width 400mm
glass Glass 200x1500mm

*available in the Alu Quartz collection

Premium+ 78mm

The prices are valid for doors with dimensions up to 1300 x 2500 mm | Standard equipment (see p. 38) any color from the RAL palette (see p. 42) | any glazing package (see p. 40)

The visualization depicts the door in the dimensions of 1000 x 2100 mm.

The prices are valid for doors with dimensions up to 1300 x 2500 mm | Standard equipment (see p. 38) any color from the RAL palette (see p. 42) | any glazing package (see p. 40)





ALU DESIGN | ALU XGLASS | **ALU QUARTZ** | ALU WOOD | PIVOT

Collection__ Alu Quartz

This unparalleled collection features doors enriched with sintered quartz, marrying modern design with the pinnacle of durability, beauty, and practicality in a pioneering selection.

Ideal for application in both modern home settings and industrial environments.

NEW

Combination of functionality and durability

Distinctive finish crafted from sintered quartz

An exclusive collection where aesthetics and functionality converge seamlessly.

An exceptionally resilient surface, ideal for pet lovers.





KB 2200

Sintered quartz
Pull handle
Abu Dhabi gr. C
QA-WS.120

Premium+ 78mm



KB 2200

Sintered quartz
Nero Greco gr. B

Premium+ 78mm



KB 2200

Sintered quartz
Pietra Grigia gr. A

Premium+ 78mm



KB 2200

Sintered quartz
Pull handle
Iron Grey gr. A
QA-WS.120

Premium+ 78mm

The prices are valid for doors with dimensions up to 1300 x 2500 mm | Standard equipment (see p. 38) any color from the RAL palette (see p. 42) | any glazing package (see p. 40)

The visualization depicts the door in the dimensions of 1000 x 2100 mm.





KB 2180

Sintered quartz
Accent
Glass

Noir Desir gr. B
Ral 9005
width 300mm
150x150mm, 5 pcs..

Premium+ 78mm



KB 2180

Sintered quartz
Pull handle
Accent
Glass

Iron Corten gr. A
QA-WS.120
Ral 9005
width 300mm
150x150mm, 5 pcs..

Premium+ 78mm



KB 2210

Sintered quartz
Accent

Osido Bruno gr. A
Ral 9005
szerokość 300mm

Premium+ 78mm



KB 2210

Sintered quartz
Pull handle
Accent

Iron Grey gr. A
QA-WS.120
Ral 9005
widht 300mm

Premium+ 78mm

The prices are valid for doors with dimensions up to 1300 x 2500 mm | Standard equipment (see p. 38) any color from the RAL palette (see p. 42) | any glazing package (see p. 40)

The visualization depicts the door in the dimensions of 1000 x 2100 mm.





KB 2220

Sintered quartz Pietra Grigia gr. A
Glass 150x1500mm

Premium+ 78mm



KB 2030

Sintered quartz Nero Greco gr. B
Glass accent Ral 9005
Width 400mm
Glass 300x1700mm

Premium+ 78mm



KB 2050

Sintered quartz Summer Dala gr. B
Glass accent Ral 9005
Width 400mm
Glass 200x1500mm
Pull handle QA-WS.120

Premium+ 78mm



KB 2200

Sintered quartz Amazonico gr. C
Pull handle QA-WS.120

Premium+ 78mm

The prices are valid for doors with dimensions up to 1300 x 2500 mm | Standard equipment (see p. 38) any color from the RAL palette (see p. 42) | any glazing package (see p. 40)



The visualization depicts the door in the dimensions of 1000 x 2100 mm



ALU DESIGN | ALU XGLASS | ALU QUARTZ | **ALU WOOD** | PIVOT

Collection Alu Wood

Distinctive blends of aluminum and genuine wood create a groundbreaking solution that unifies modernity, durability, and the essence of nature.

The ideal selection for contemporary homes and those inspired by a quaint, rustic ambiance.

Select a model from this collection to infuse your home with a touch of nature's essence.



A product built to last for years.

Designs inspired by nature's elegance.

The fusion of contemporary design, lasting durability, and natural elements.

The perfect blend for homes that harmonize design with natural elements.





KB 3000

Timber finish Transparent
 Accent brushed
 Ral 9005
 Pull handle Widht 400mm
 QA.10 140

Premium+ 78mm



KB 3010

Timber finish Transparent
 Pull handle brushed
 QA-WW.120

Premium+ 78mm



KB 3020

Timber finish Transparent
 Pull handle brushed
 QA-WW.120

Premium+ 78mm

The prices are valid for doors with dimensions up to 1300 x 2500 mm | Standard equipment (see p. 38) any color from the RAL palette (see p. 42) | any glazing package (see p. 40)





ALU DESIGN | ALU XGLASS | ALU QUARTZ | ALU WOOD | PIVOT

Collection Pivot

The Pivot collection is expertly crafted for clients seeking to imbue their homes with a touch of modern elegance.

Featuring an advanced opening mechanism, this series enables the crafting of expansive doors that redefine spatial boundaries. Drawing on the diverse aesthetics of the Alu Design, Alu Xglass, Alu Quartz, and Alu Wood collections, Pivot offers boundless creative potential, allowing for the design of statement doors that enhance the unique character of any home.

Engineered with a revolutionary pivot axis shift, our doors can achieve dimensions of up to 1500mm in width and 3000mm in height. Moreover, the addition of side and top lights presents an opportunity to forge entranceways that are not just doorways, but grand statements of modern architectural beauty.

Contemporary architectural elegance

Dimensions of up to 1500mm in width and 3000mm in height

Featuring an advanced opening mechanism

Pivot offers boundless creative potential



BASIC EQUIPMENT



1 System	Exterior doors with high thermal insulation, double-leaf overlapping, KB PREMIUM 75 mm.
2 Locks	G-U SECURY MR2, 3-point lock, stainless steel (KB 4.10) Security bar along the entire length of the door, stainless steel
3 Hinges	DR. Hahn 3-part roller hinge, 3 pcs, anode EV1 (KB 1.30)
4 Profile cylinder	Profile cylinder BKS 88 with emergency function, 5 keys (KB 1.40)
5 Pull handle	Pull handle P10 - 600 mm, ø 30 mm, stainless steel (P10.60)
6 Rosette	Round rosette, flush with the surface, stainless steel (KB 1.51)
7 Inside lever handle	Inside lever handle H1, Inox (KB 1.60)
8 Colour	Fine structure (p.42)
9 Glass	Safety glass, triple glazing 65 mm, with a warm edge



2 G-U SECURY MR2, 3-point locking, stainless steel



3 DR. Hahn 3-part roller hinge Anode EV1



5 Pull handle P10 600 mm, ø 30 mm, Inox



6 Round rosette, flush with the surface, stainless steel

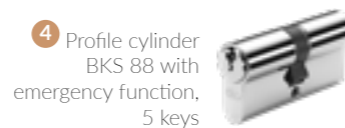

4 Profile cylinder BKS 88 with emergency function, 5 keys



7 Inside lever handle H1, Inox

CONSTRUCTION OF THE KOBBE DOOR

- 1 High-quality waterproof aluminium sheet with a thickness of 3mm EN AW1050 from the outside
- 2 Infill: A cutting-edge 70 mm deep XPS panel that offers exceptional thermal insulation and robust durability
- 3 High-quality aluminium sheet with a thickness of 2 mm EN AW1050 from the inside
- 4 EPDM gaskets designed to withstand a variety of weather conditions, including extreme temperatures, ageing, UV exposure, and moisture.
- 5 Advanced multi-chamber thermal insulation guarantees superior thermal efficiency, effectively minimizing the thermal bridging effect.
- 6 Warm 14 mm flat threshold with thermal break, improves comfort and safety.
- 7 Swing door seal that insulates both thermally and acoustically. - The thermal break minimises the escape of heat from the house and thus maintains the correct temperature inside the building.
- 8 Safety glass, 3 panes 64mm Ug - 0.5 W/m2K, black spacers.
- 9 Safety glass, 4-pane package 84mm Ug - 0.5 W/m2K, black spacers.

KOBBE PREMIUM 75

Ud Value	from 0,95 W ² K
Sash	75mm
Frame	75mm
Glass	Triple-glazed, 64mm
Opening direction	inwards / outwards
Safety	RC2 (option)



KOBBE PRESTIGE 95

Ud value	from 0,79 W ² K
Sash	95mm
Frame	75mm
Glass	Quadruple glazing, 78mm
Opening direction	inwards
Safety	RC2 (option)

*Door section with the 95mm sash. Frame remains at 75 mm
Frame remains at 75 mm

GLASS

In addition to a wide variety of panels, we offer a large selection of glass types for the door panels and side panels. The well-matched glazing gives the door a unique character. In the standard version, the doors are fitted with triple laminated safety glass on the outside.

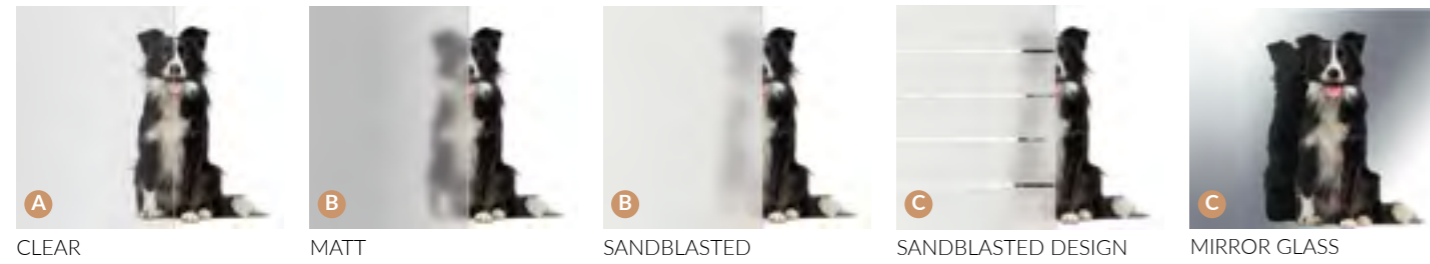

A CLEAR **B** MATT **B** SANDBLASTED **C** SANDBLASTED DESIGN **C** MIRROR GLASS



B C ANTISOL/STOPSOL GREY **B C** ANTISOL/STOPSOL GREEN **B C** ANTISOL/STOPSOL BROWN **C** STOPSOL CLEAR **C** PLANIBEL DARK GREY

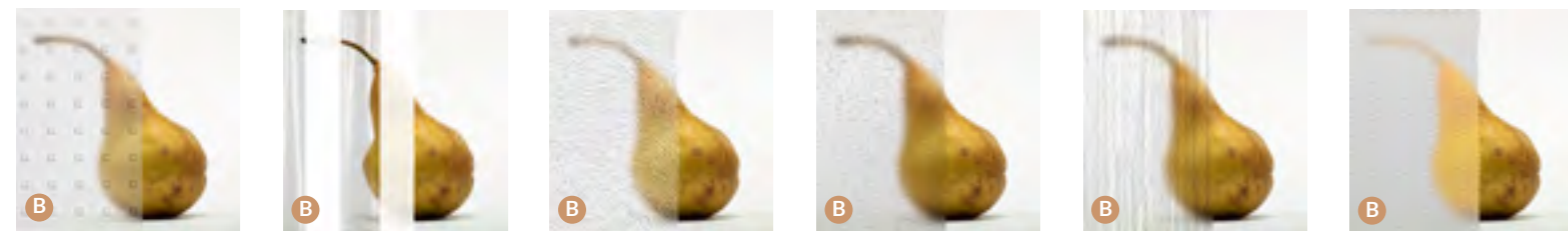

B MASTER-POINT **B** FLUTES **B** CHINCHILA **B** CREPI **B** KURA **B** MASTER-CARRE

GROUP	Type of glass
A	Clear
B	Antisol Matt Sandblasted Texture glass
C	Stopsol Mirror Glass Planibel Dark Grey Sandblasted Design

Set-ups



Sidelights

Width
400 mm
600 mm
800 mm
1000 mm
1200 mm
1400 mm

Toplights

Width x Height
1200 x 400 mm
1700 x 400 mm
2200 x 400 mm
1200 x 600 mm
1700 x 600 mm
2200 x 600 mm
1200 x 800 mm
1700 x 800 mm
2200 x 800 mm



STRUCTURAL FINISH // ALU DESIGN

RAL 3004 YG304F		RAL 3005 YG305F		RAL 5010 YJ310F		RAL 5024 YJ324F		RAL 6005 YK305F		RAL 6009 YK309F		RAL 7012 YL312F		RAL 7015 YL315F		RAL 7016 YL316F		RAL 7021 YL321F		RAL 7035 YL335F		RAL 7040 YL340F		
RAL 8011 YM311F		RAL 8014 YM314F		RAL 9005 YN305F		RAL 9007 S2307G		RAL 9010 YA310F		RAL 9016 YA316F		RAL 8022 Tiger Drylac 29/60861		RAL 5023 YJ323F		RAL 7024 YL324F		RAL 6029 YK329F		RAL 5003 YJ303F		Any RAL colour		



TIMBER/CONCRETE-LOOK FINISH // ALU DESIGN

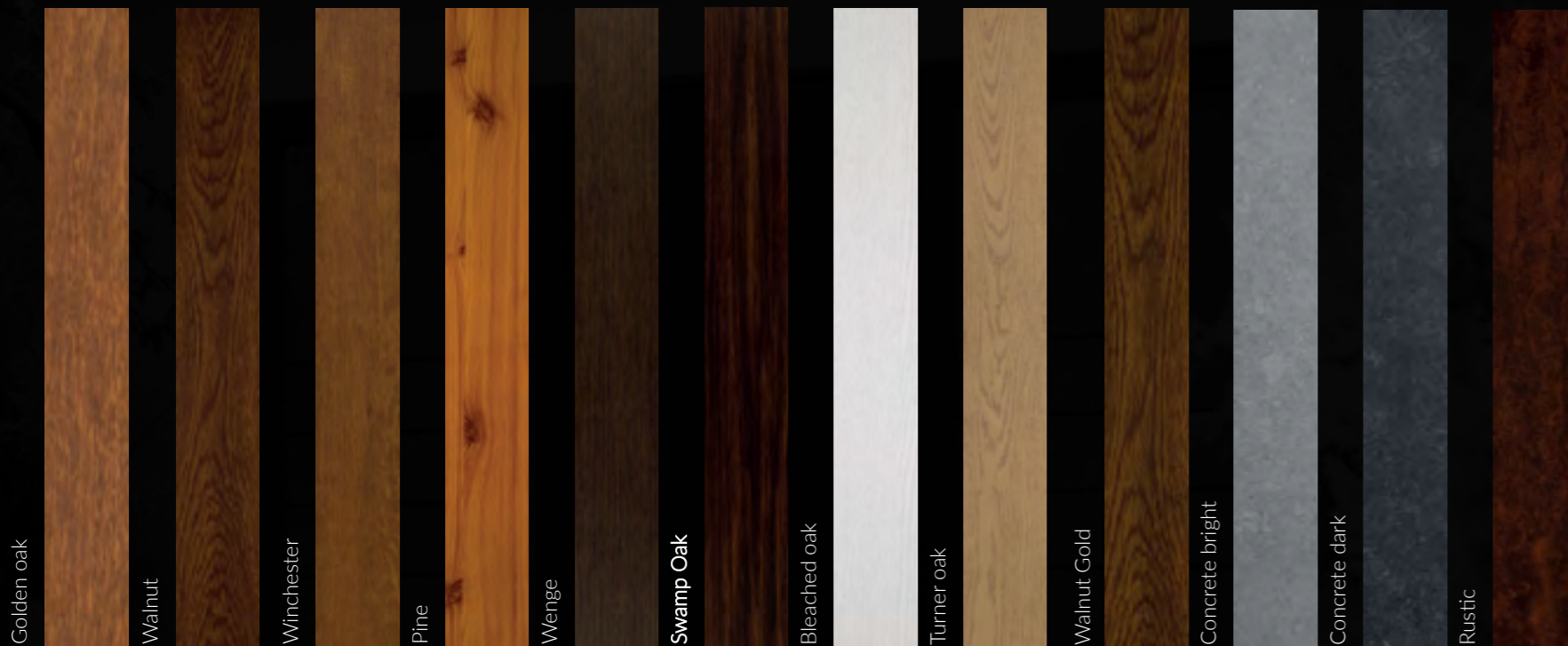

*Not available on models
KB110, KB120, KB140, KB340



SINTERED QUARTZ AND TIMBER //ALU QUARZ I ALUWOOD



Group	Sintered Quartz
A	Pietra Grigia, Ossido Bruno, Summer Dala
B	Nero Greco, Noir Desir, Iron Corten, Iron Grey
C	Abu Dhabi, Amzonico

*Alu Wood oak wood in structured brushed or smooth finish



P U L L H A N D L E S

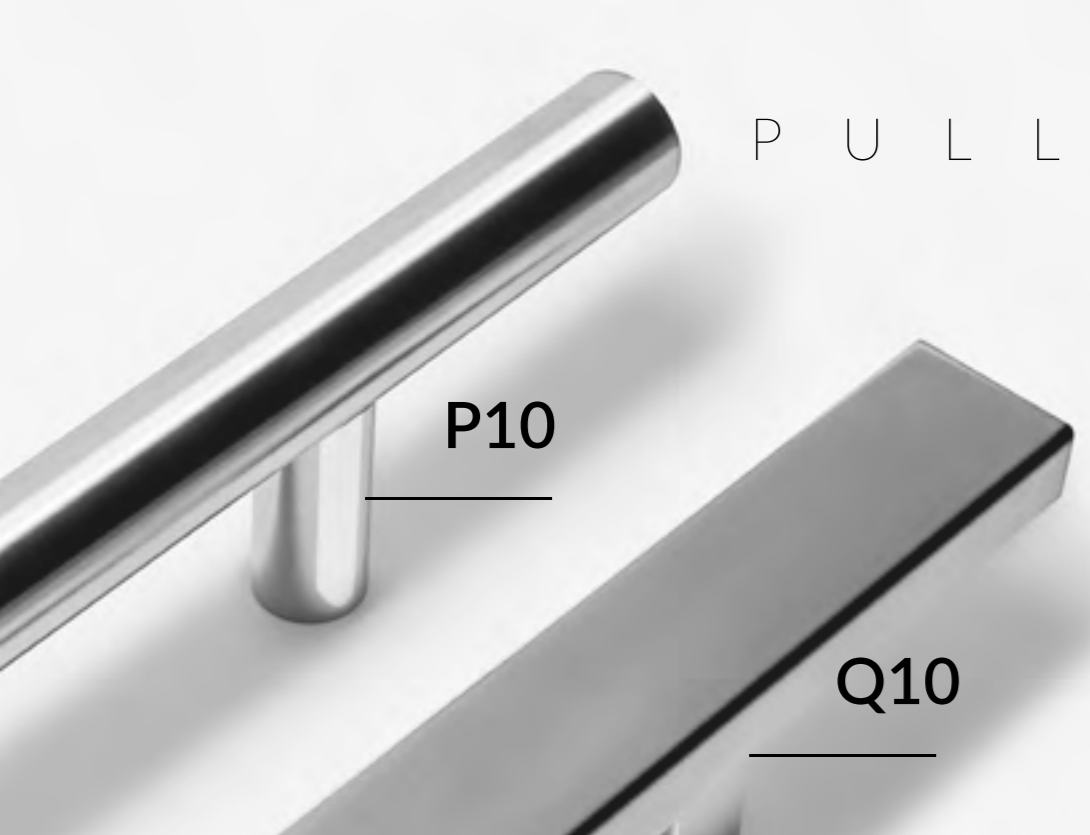

P10

Q10



QA35

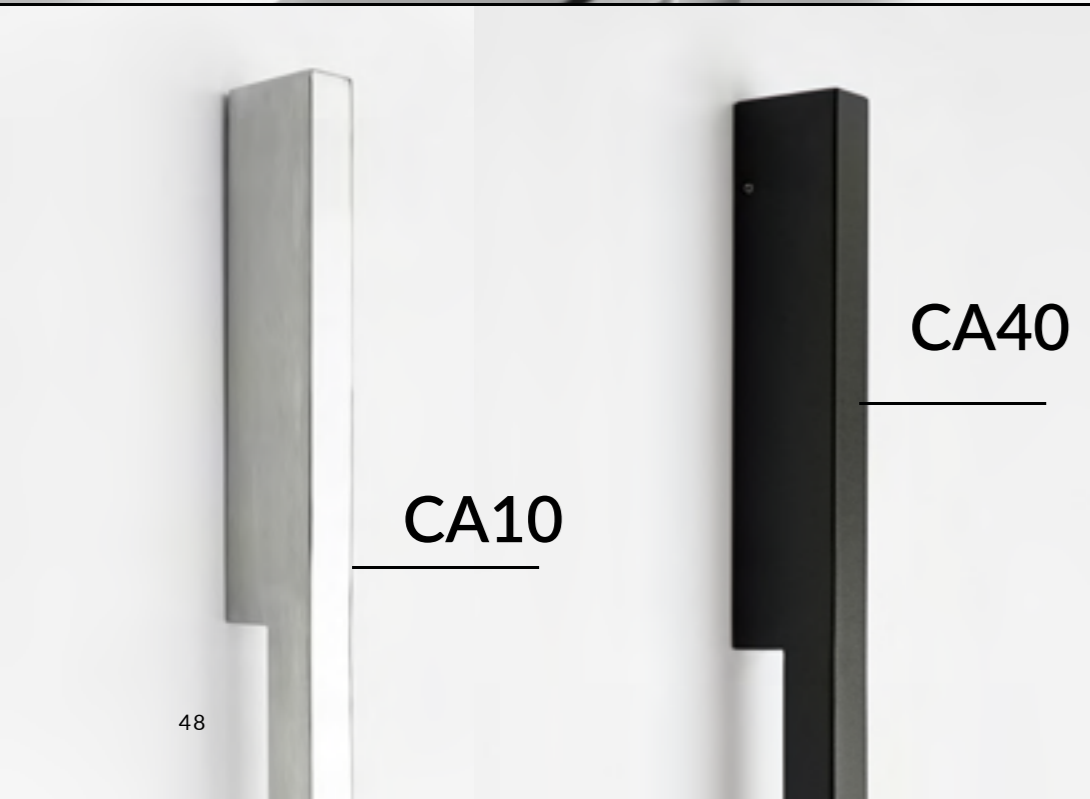

CA10

CA40

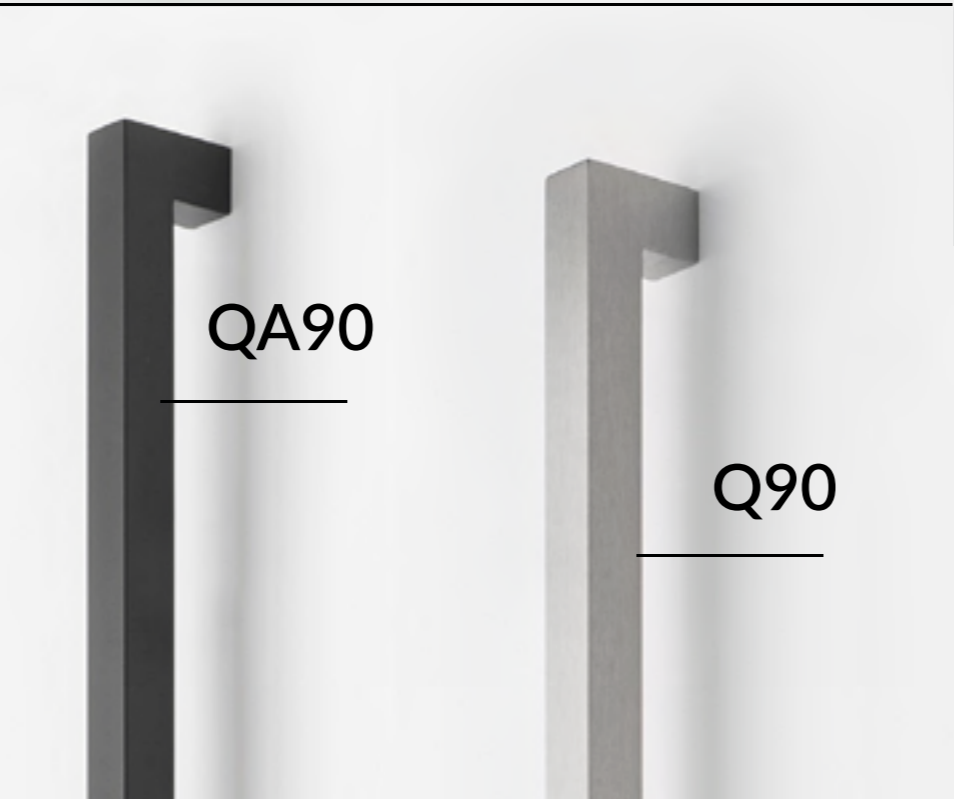

QA90

Q90

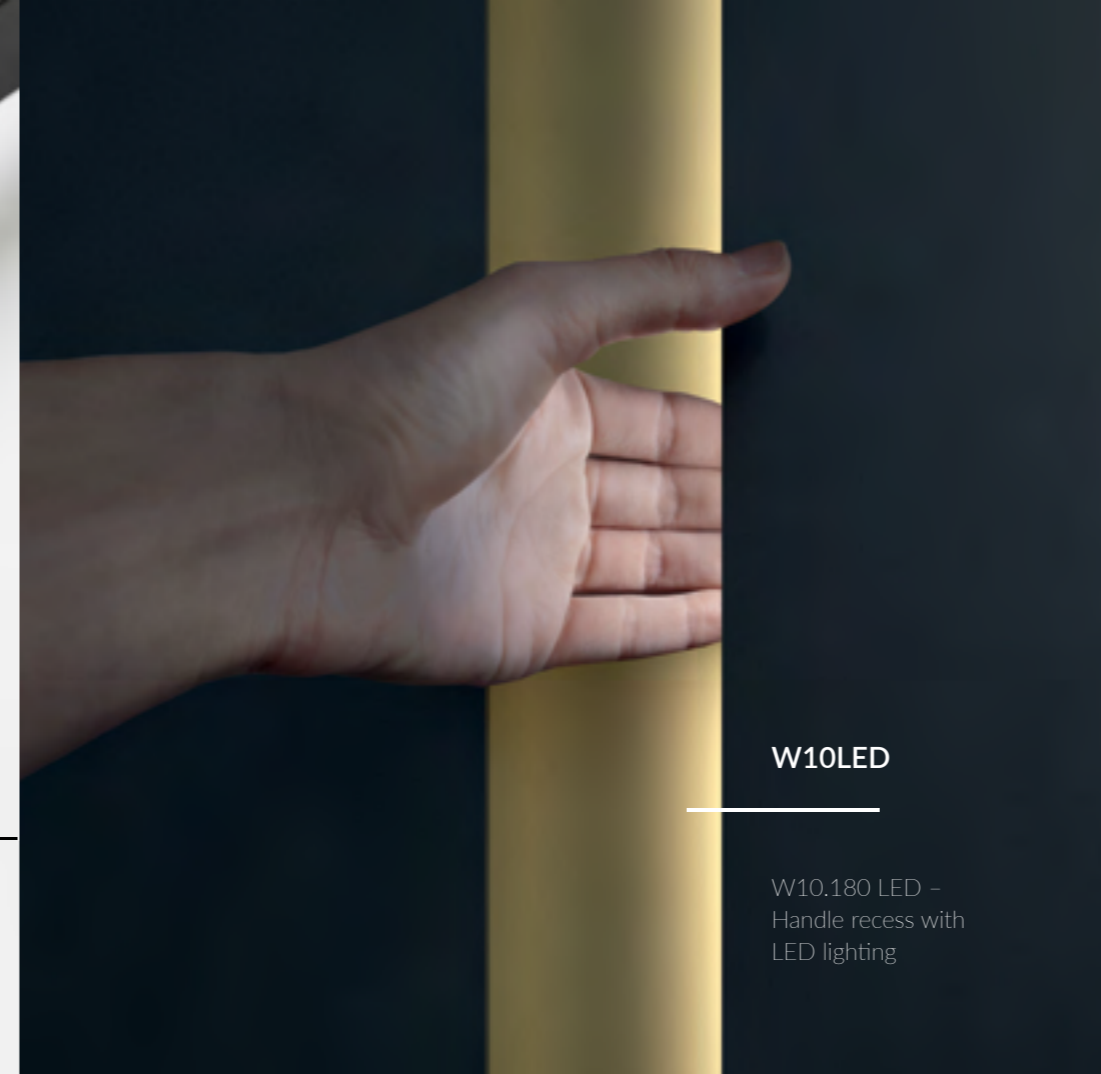

W10LED

W10.180 LED -
Handle recess with
LED lighting

Handle Recess, W10

Any colour from the RAL palette (see p. 42),
optional LED lighting.



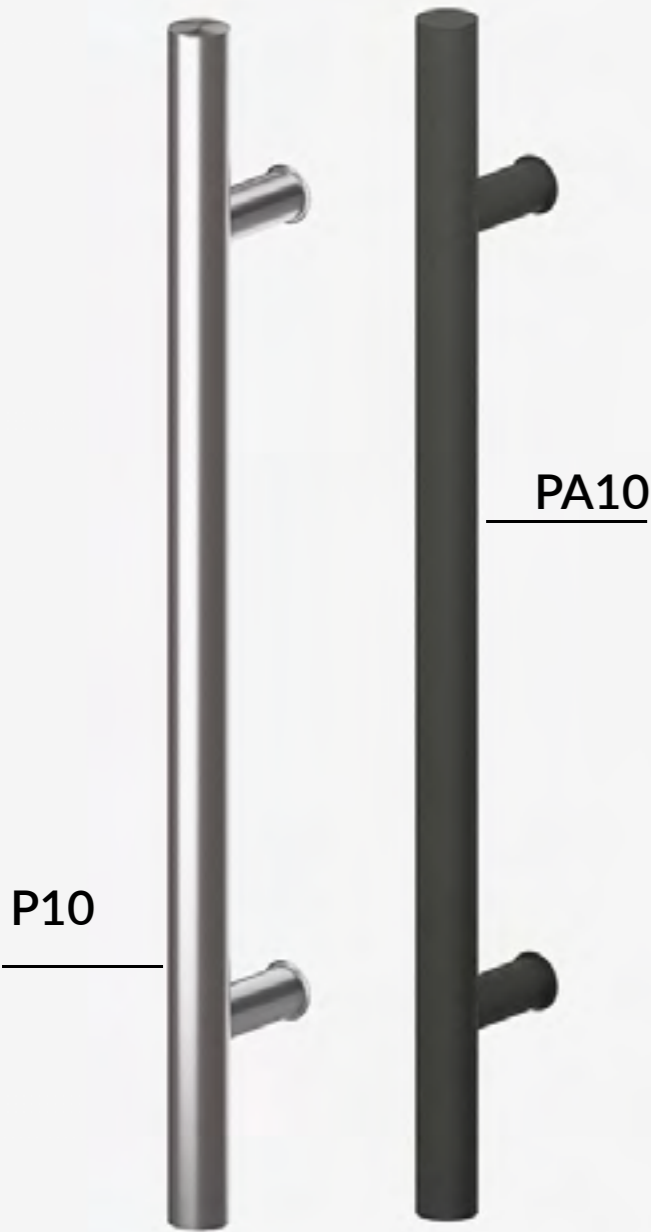

P10

PA10

P10 Ø 30mm, Ø 40mm**, Inox

Length	Code	LED lighting*
600 mm	P10.60	2 pcs. LED
800 mm	P10.80	3 pcs. LED
1000 mm	P10.100	4 pcs. LED
1200 mm	P10.120	5 pcs. LED
1400 mm	P10.140	6 pcs. LED
1600 mm	P10.160	7 pcs. LED
1800 mm	P10.180**	8 pcs. LED
2000 mm	P10.200**	9 pcs. LED



PA10 Ø 30mm, Ø40 mm**, aluminium, Black

Length	Code	LED lighting*
600 mm	PA10.60	2 pcs. LED
800 mm	PA10.80	3 pcs. LED
1000 mm	PA10.100	4 pcs. LED
1200 mm	PA10.120	5 pcs. LED
1400 mm	PA10.140	6 pcs. LED
1600 mm	PA10.160	7 pcs. LED
1800 mm	PA10.180**	8 pcs. LED
2000 mm	PA10.200**	9 pcs. LED



* A cable conduit (KB 1.96) is required for the LED lighting (see p. 66).

Q10 40 x 20 mm, Inox

Length	Code	LED lighting*
600 mm	Q10.60	2 pcs. LED
800 mm	Q10.80	3 pcs. LED
1000 mm	Q10.100	4 pcs. LED
1200 mm	Q10.120	5 pcs. LED
1400 mm	Q10.140	6 pcs. LED
1600 mm	Q10.160	7 pcs. LED
1800 mm	Q10.180	8 pcs. LED
2000 mm	Q10.200	9 pcs. LED



QA10 40 x 20 mm, aluminium, Black

Length	Code	LED lighting*
600 mm	QA10.60	2 pcs. LED
800 mm	QA10.80	3 pcs. LED
1000 mm	QA10.100	4 pcs. LED
1200 mm	QA10.120	5 pcs. LED
1400 mm	QA10.140	6 pcs. LED
1600 mm	QA10.160	7 pcs. LED
1800 mm	QA10.180	8 pcs. LED
2000 mm	QA10.200	9 pcs. LED



* A cable conduit (KB 1.96) is required for the LED lighting (see p. 66).

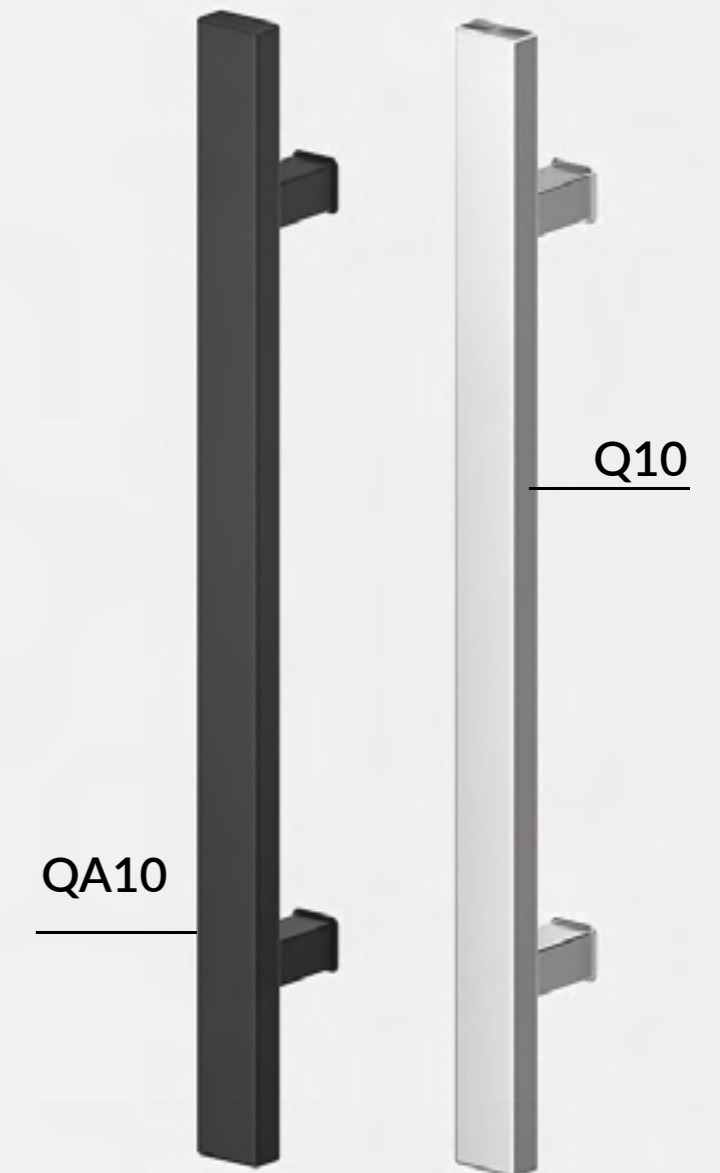

QA10

Q10

QA90



Q90

Q90

40 x 40 mm, Inox

Length	Code	LED lighting*
600 mm	Q90.60	2 pcs. LED
800 mm	Q90.80	3 pcs. LED
1000 mm	Q90.100	4 pcs. LED
1200 mm	Q90.120	5 pcs. LED
1400 mm	Q90.140	6 pcs. LED
1600 mm	Q90.160	7 pcs. LED
1800 mm	Q90.180	8 pcs. LED
2000 mm	Q90.200	9 pcs. LED

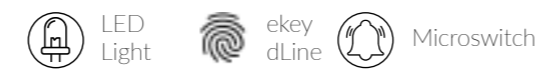

QA90

40 x 40 mm, aluminium, Black

Length	Code	LED lighting*
600 mm	QA90.60	2 pcs. LED
800 mm	QA90.80	3 pcs. LED
1000 mm	QA90.100	4 pcs. LED
1200 mm	QA90.120	5 pcs. LED
1400 mm	QA90.140	6 pcs. LED
1600 mm	QA90.160	7 pcs. LED
1800 mm	QA90.180	8 pcs. LED
2000 mm	QA90.200	9 pcs. LED



* A cable conduit (KB 1.96) is required for the LED lighting (see p. 66).

Q35

35 x 35 mm, Inox

Length	Code	LED lighting*
1200 mm	Q35.120	LED-Strip
1400 mm	Q35.140	LED-Strip
1600 mm	Q35.160	LED-Strip
1800 mm	Q35.180	LED-Strip



QA35

35 x 35 mm, Black

Length	Code	LED lighting*
1200 mm	QA35.120	LED-Strip
1400 mm	QA35.140	LED-Strip
1600 mm	QA35.160	LED-Strip
1800 mm	QA35.180	LED-Strip



* A cable conduit (KB 1.96) is required for the LED lighting (see p. 66).

Q35

QA35



C 40

CA 40

C 40

40 x 40 mm, Inox**

Length	Code	LED lighting*
1600 mm	C40.160	LED strip
1800 mm	C40.180	LED strip
2000 mm	C40.200	LED strip
2200 mm	C40.220	LED strip



CA 40

40 x 40 mm, Inox Black

Length	Code	LED lighting*
1600 mm	CA40.160	LED strip
1800 mm	CA40.180	LED strip
2000 mm	CA40.200	LED strip
2200 mm	CA40.220	LED strip



* A cable conduit (KB 1.96) is required for the LED lighting (see p. 66).
 ** LED strip, cool white light.

SPSG-16

Ø 30mm, Inox

Length	Code
1200 mm	SPSG-16-1200
1400 mm	SPSG-16-1400
1600 mm	SPSG-16-1600
1800 mm	SPSG-16-1800

PUSH HANDLES WITH INTEGRATED CAMERA AND DIGITAL DOOR VIEWER

Enhance your home's security with our push handles that feature an integrated camera and digital door viewer. This innovative setup includes a 150° wideangle lens, ensuring comprehensive coverage of the area outside your door. Easily view who is outside without the need to open the door, providing a seamless and secure way to monitor your entryway.

SPSG-18

40 x 20 mm, Inox

Length	Code
1200 mm	SPSG-18-1200
1400 mm	SPSG-18-1400
1600 mm	SPSG-18-1800
1800 mm	SPSG-18-1800



4.3-inch LED screen, mounted flush with the panel on the inside of the door.

SPSG-18

Pull handles with Custom Inlays

NEW

This collection showcases our distinctive push handles, available with coatings in any shade from our slate or wood color ranges (refer to the Alu Quartz and Alu Wood color palettes). For our Alu XGlass series, we provide an option of black glass. Additionally, these handles are offered with a choice of a stainless steel or black finish, allowing for further customization to suit your style.



Q-W

40 x 20 mm, Inox
Inlay: Q-WS - Quartz/Q-WG - Xglass/Q-Ww - Timber

Length	Code	LED lighting*
1200 mm	Q-WS.120	LED strip
1400 mm	Q-WS.140	LED strip
1600 mm	Q-WS.160	LED strip
1800 mm	Q-WS.180	LED strip
1200 mm	Q-WG.120	LED strip
1400 mm	Q-WG.140	LED strip
1600 mm	Q-WG.160	LED strip
1800 mm	Q-WG.180	LED strip
1200 mm	Q-WW.120	LED strip
1400 mm	Q-WW.140	LED strip
1600 mm	Q-WW.160	LED strip
1800 mm	Q-WW.180	LED strip



LED Light



Microswitch

* A cable conduit (KB 1.96) is required for the LED lighting (see p. 66).
* LED strip, cool white light

QA-W

40 x 20 mm, Black
Inlay: QA-WS - Quartz/QA-WG - Xglass/QA-Ww - Timber

Length	Code	LED lighting*
1200 mm	QA-WS.120	LED strip
1400 mm	QA-WS.140	LED strip
1600 mm	QA-WS.160	LED strip
1800 mm	QA-WS.180	LED strip
1200 mm	QA-WG.120	LED strip
1400 mm	QA-WG.140	LED strip
1600 mm	QA-WG.160	LED strip
1800 mm	QA-WG.180	LED strip
1200 mm	QA-WW.120	LED strip
1400 mm	QA-WW.140	LED strip
1600 mm	QA-WW.160	LED strip
1800 mm	QA-WW.180	LED strip



LED Light



Microswitch

* A cable conduit (KB 1.96) is required for the LED lighting (see p. 66).
* LED strip, cool white light

Please refer to page 46 for the available inlays. Q-Ws and QA-Ws handles (filled with sintered quartz) are available for doors from the Alu-Quartz collection using the same sinterd quartz.

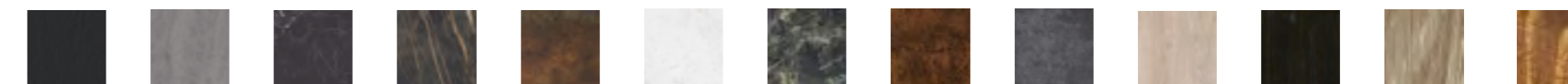



Q90 P 40 x 20 mm, Horizontal, Inox
QA90 P 40 x 20 mm, Horizontal, aluminium, Black

Length	Code	LED backlight*
800 mm	Q90.80 Horizontal	3 pkt. LED
800 mm	QA90.80 Horizontal	3 pkt. LED



* Exclusively for the KB1030 variant
 **A cable conduit (KB 1.96) is required for the LED lighting (see p. 66).



LIVELLO 350 x 60 mm, Horizontal, Inox

Length	Code.
350 mm	LIVELLO (350 x 60 mm)

* Exclusively for the KB1000 variant

Handles

Code	Description	Colours
KB 1.60	Lever handle H1	Inox Black
KB 1.61	Lever handle H2	Inox Black Anthracite Satin Copper Satin Gold Gold PVD
KB 1.62	Lever handle H3	Inox Black Anthracite Satin Copper Satin Gold Gold PVD
KB 1.63	Lever handle H4	Inox Black
KB 1.64	Lever handle H5	Inox Black



KB 1.60 Lever handle H1 KB 1.61 Lever handle H2 KB 1.62 Lever handle H3 KB 1.63 Lever handle H4 KB 1.64 Lever handle H5



KB 1.60 Lever handle H1, Black KB 1.61 Lever handle H2, Black KB 1.62 Lever handle H3, Black KB 1.63 Lever handle H4, Black KB 1.64 Lever handle H5, Black



Lever handle H2/H3, Anthracite Lever handle H2/H3, Satin Copper Lever handle H2/H3, Satin Gold Lever handle H2/H3, Gold PVD

Locks GU-SECURY

G.U-SECURY Automatic
Automatic multi-point locking system: Simply close the door to activate the locking mechanism automatically, engaging a 20 mm throw. This system includes two latch bolts that lock instantly and are designed to resist being forced back.

G.U-SECURY Automatic-DR
The Automatic Double-Bolt Lock enhances security while ensuring ease of operation for exterior doors. This advanced multi-point locking system seamlessly combines automatic latch bolts with locking hooks that engage simultaneously and automatically.

G.U-SECURY Automatic 6
Six automatic locking bolts for increased burglary protection.

G.U-SECURY Automatic TE
This system allows for the temporary manual disengagement of the automatic lock, enabling the door to be opened from the outside without a key.

G.U-SECURY MR
Multi-point locking system featuring two robust bolts that secure the door from top to bottom. Each bolt is fortified with a hardened steel insert, rendering it impervious to sawing.

G.U-SECURY DR
The GU-SECURY DR multi-point locking system is a key-operated mechanism that integrates the benefits of hook and solid bolt designs into a dual-bolt configuration. G.U locking hooks are reinforced with a hardened steel insert, ensuring they are resistant to sawing.



Code	Description
KB 4.10	G-U MR2, 3-point locking system, Inox
KB 4.11	G-U MR2, 3-point locking system + T-catch door restrictor, Inox
KB 4.12	G-U DR, 5-point locking system, Inox
KB 4.20	G-U Automatic 3, Automatic 3-point lock, Inox
KB 4.21	G-U Automatic 3 TE, automatic 3-point locking system with daytime function ,Inox
KB 4.22*	G-U Automatic 3, automatic 3-point locking system with A-Opener, Inox
KB 4.23	G-U Automatic 3, 3-point locking system + T-catch door restrictor, Inox
KB 4.24*	G-U Automatic 3, automatic 3-point locking system with A-Opener + T-catch door restrictor, Inox
KB 4.30	G-U Automatic-DR automatic 5-point locking system, Inox
KB 4.31*	G-U Automatic ADR automatic 5-point locking system with A-opener, Inox
KB 4.40	G-U Automatic A6 automatic 7-point locking system , Inox
KB 4.41*	G-U Automatic A6 automatic 7-point locking system with A-Opener, Inox

*A cable conduit (KB 1.96) is required for the LED lighting (see p. 66).

** Locks fitted with strike plates

E-Opener | Day/ Night function

Code.	Description
KB 1.20**	Day/night function
KB 1.21**	E-Opener

** For locks KB 4.10, KB 4.11, KB 4.12, KB 4.21

Mechanical locks

Dead bolts

KB 4.10, KB 4.11



Dead bolts and hooks top and bottom

KB 4.12

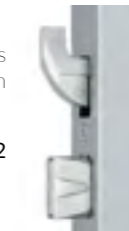

Strike plates aligned with door height on all locks.



KB 1.20



KB 1.21

Day-release or E-Opener equipped with a mechanical lever, allowing you to open the door by pulling on the handle without having to press the door handle.

KB 4.10, KB 4.11, KB 4.12, KB 4.21

Automatic locks

Automatic dead bolts
The automatic deadbolts extend by 20 mm and lock securely into place when the door is closed, preventing them from being pushed back.

KB 4.20, KB 4.21, KB 4.22, KB 4.23, KB 4.24



Automatic dead bolts and hooks
The automatic deadbolts, along with the locking hooks, provide enhanced security.

KB 4.30, KB 4.31



Two Automatic dead bolts
The automatic deadbolts extend by 20 mm and lock securely into place when the door is closed, preventing them from being pushed back..

KB 4.40, KB 4.41



T-catch door restrictor
Integrated rigid system with toggle handle

KB 4.11, KB 4.23, KB 4.24



KB 3.10 The ekey dLine system is seamlessly installed within the door itself, featuring a stainless steel finish. It can be easily managed through the ekey bionyx app, allowing for straightforward control of the door's security features.

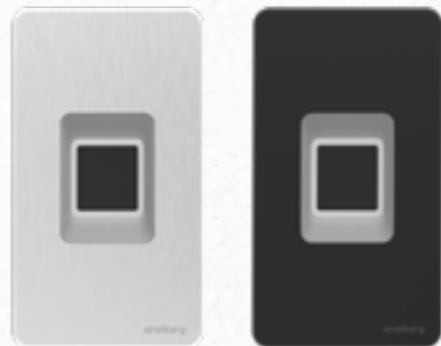

KB 3.10 ekey dLine Inox | Black

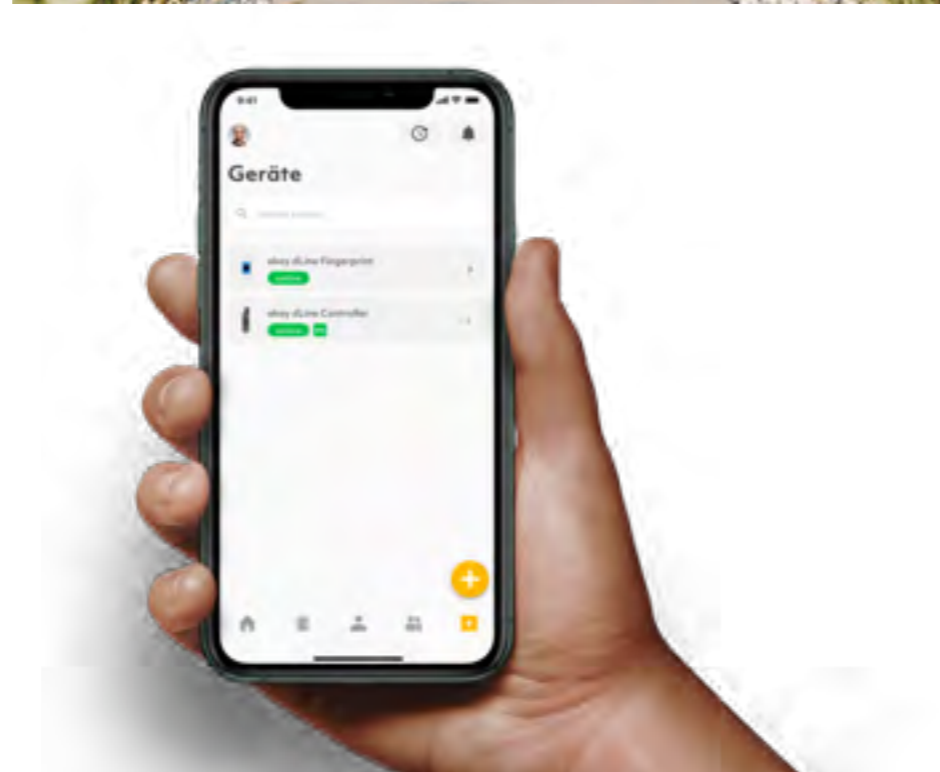

Access control



KB 3.12 ekey keypad Integra
Inox | Anthracite | White

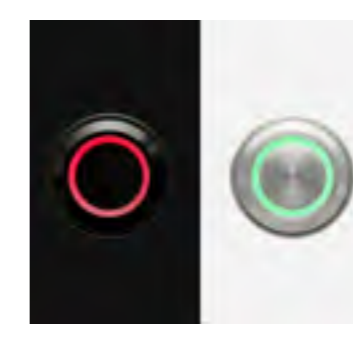
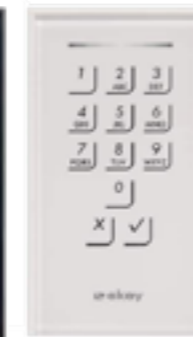

KB 3.22 Day / night button
Black | Inox



KB 3.11 ekey dLine
Pull handle P series,
Inox



KB 3.11 ekey dLine
Pull handle Q series, black



KB 3.11 ekey dLine
Pull handle Q series,
Inox

Code	Description
KB 3.10*	ekey dLine door leaf, Inox Black
KB 3.11*	ekey dLine in pull handle QA Series, Inox Black
KB 3.12*	ekey keypad Integra, Inox Anthracite White
KB 3.20*	Microswitch in the push handle, single function, without backlighting
KB 3.22	Microswitch activation/deactivation button in the push handle with two-color LED backlighting. Inox Black

* ekey dLine not available for PA10 handles.

Lock cylinders



KB 1.40



KB 1.42



KB 1.41



KB 1.43



PZ 88 / 86 Key



Livius Key

Code	Description
KB 1.40	Cylinder BKS 88, with safety function
KB 1.40 B	Cylinder BKS 88, with safety function, Black
KB 1.41	Knob cylinder BKS 86
KB 1.41 B	Knob cylinder BKS 86, Black
KB 1.42	Cylinder Livius
KB 1.43	Knob cylinder Livius
KB 1.46	EVVA cylinder
KB 1.46 B	EVVA cylinder, Black
KB 1.47	Knob cylinder EVVA
KB 1.47 B	Knob cylinder EVVA, black



All models available
in RC2 resistance
class

Hinges



KB 1.30 DR. Hahn 3 part hinge



KB 1.32 Concealed hinge, ROTO Solid C

Code	Description
KB 1.30	DR. Hahn 3-part hinge, 3 pcs., Anode EV1
KB 1.30R	DR. Hahn 3-part hinge, 3 pcs., Coloured
KB 1.30I	DR. Hahn 3-part hinge, 3 pcs., Inox
KB 1.32	Concealed hinges, ROTO Solid C, 3 pcs, black
KB 1.33	Concealed hinge DR. Hahn, (Prestige 95)



KB 1.91

KB 1.92

KB 1.93



KB 1.94

KB 1.95

KB 1.96



KB 1.97

KB 1.98

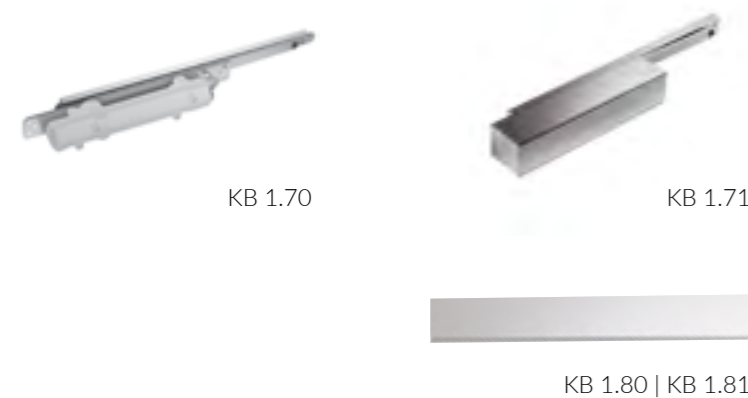

KB 1.70

KB 1.71

KB 1.80 | KB 1.81

Accessories

Code	Description
KB 1.91	Door viewer
KB 1.92	Digital door viewer
KB 1.93	Digital door viewer with doorbell
KB 1.94	Magnetic coupling
KB 1.95	Deadbolt position sensor for alarm connection (1 point)
KB 1.96*	Concealed plug-in cable coupling
KB 1.97	LED lighting remote control
KB 1.98	LED control - WiFi gateway with Mi-Light app.

Door closers

Code	Description
KB 1.70	Concealed door closer DORMA ITS96
KB 1.71	DORMA TS93 door closer with rail and rotary latch

Kick plates

Code	Description
KB 1.80	80 mm kick plate, flush with panell
KB 1.81	30 mm kick plate, flush with panell

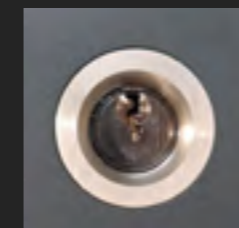

KB 1.51

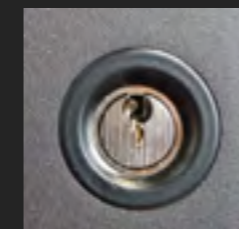

KB 1.51B

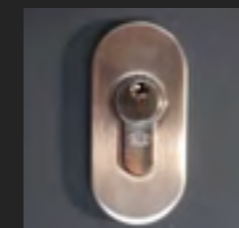

KB 1.52

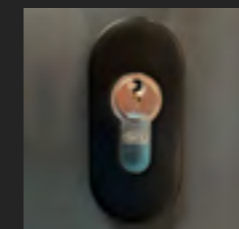

KB 1.52 B

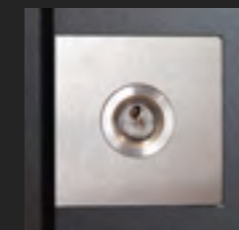

KB 1.53

Door extensions

Code	Height
KB 5.23	23mm
KB 5.30	30mm
KB 5.50	50mm
KB 5.90	90mm
KB 5.130	130mm

Escutcheons

Code	Description
KB 1.51	round escutcheon, Inox
KB 1.51B	round escutcheon, Black
KB 1.52	oval escutcheon, Inox
KB 1.52B	oval escutcheon, Black
KB 1.53	Scratch protection escutcheon, Inox
KB 1.55	oval anti-burglar escutcheon, Inox
KB 1.56	square anti-burglar escutcheon, Inox
KB 1.57	round anti-burglar escutcheon, Inox

Modulotherm

Code	Height
KB 2.20	20 mm
KB 2.40	40 mm
KB 2.60	60 mm
KB 2.80	80 mm
KB 2.100	100 mm
KB 2.120	120 mm
KB 2.140	140 mm
KB 2.160	160 mm
KB 2.180	180 mm
KB 2.200	200 mm
KB 2.220	220 mm
KB 2.240	240 mm
KB 2.260	260 mm

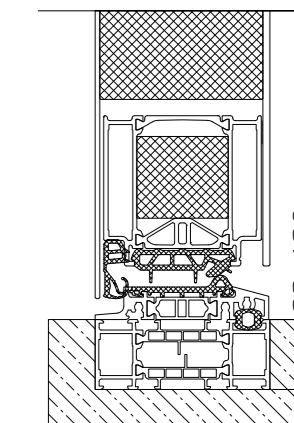

System extension

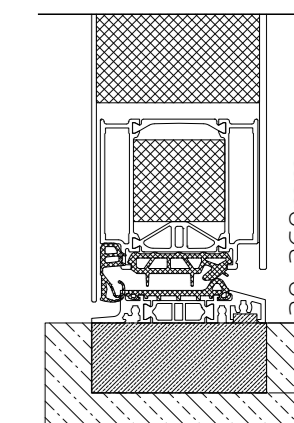

Modulotherm base



KB 1.55



KB 1.56



KB 1.57

K O B B E

ALUMINIUM DOORS

UK Distribution:

Modern Doors Ltd
Tel. 0203 1503 103
info@modern-doors.co.uk
www.modern-doors.co.uk



**MODERN
DOORS**